



Catalog No.	Type:
Job Name:	

8300 Series

T8 Side Mount Strip- 1 Lamp



General Characteristics:

Lamp Type: 1 or 2 T8 Lamps
 Ballast Type: Electronic Ballast
 Standard Voltage: 120 (Universal 120-277 optional)
 Options: Dimming Ballast, Emergency Ballast, With Lamps, 6ft Cord and Plug, Asymmetrical Reflector
 Mounting: Surface or Pendant Mount
 Additional Info: UL Listed & Title 24 Compliant

Features & Specifications:

The 8300 Series is a functional multi-purpose side mount strip that incorporates premium performance and construction durability. This series can be installed using various mounting methods and numerous options and accessories are available. The 8300 Series can be the illumination solution in commercial, industrial and residential applications. Ideal for warehouses, garages, utility rooms, and production lines.

- T8 side mount strip available in a large variety of configurations
- Mounted individually or in continuous rows
- Housing is pre-painted stamped die- formed heavy gauge steel
- Housing constructed with numerous knockouts for chain hanger, conduit, pull switch, starter and convenience outlet
- White polyester polymer with a minimum of 82% reflectivity
- Narrow body to fit confined spaces
- All parts snap together for ease of installation
- Suitable for damp location

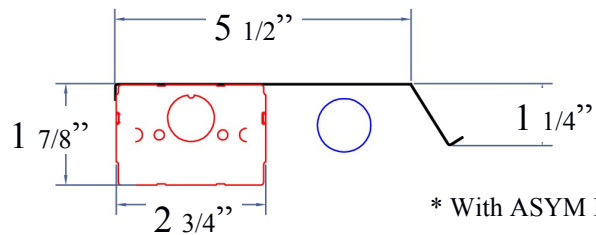
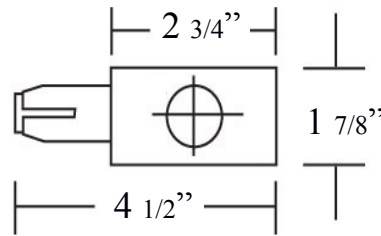

Catalog Ordering: Example: 8348-132- DIM-WL

--	--	--	--

FAMILY TYPE	LENGTH IN INCHES/ LAMPING	VOLTAGE	OPTIONS
83	18-EL (1- F15T8)*	120 (120 Volt)	WL (With Lamps)
	24-117 (1- F17T8)	UNV (120-277 Volt)**	PLG (6' SJT Cord & Plug)
	36-125 (1- F25T8)	DIM (Dimming Ballast)**	EMR (450 Lumen Emergency Ballast)**
	48-132 (1- F32T8)		EMR 1400 (1400 Lumen Emergency Ballast)**
	72-125T (2- F25T8)		ASYM (Asymmetrical Reflector)
	96-132T (2- F32T8)		

* 8318-EL is not available with a Universal, Dimming or Emergency Ballast

** Not available in the 18" fixture

Specifications and Dimensions Subject to change without notice

FSC Lighting 9120 Center Avenue, Rancho Cucamonga, CA 91730 Ph 909-948-8878 Fax 909-948-8510

