



7500 Series

Vaportite Enclosed Strip



General Characteristics:

Lamp Type: 1, 2 or 4 Lamp T5 or T8
 Ballast Type: Electronic Ballast
 Standard Voltage: Universal 120-277
 Options: Dimming Ballast, Step Dimming Ballast, Emergency Ballast, Occupancy Sensor, Wet Occupancy Sensor, Daylight/ Occupancy Sensor, Sensor Extension Bracket, Polycarbonate Diffuser, Radial Lens, With Lamps, Tamper Proof Latches
 Additional Info: UL Certified, NSF Rated , IP 65 & IP 67 Rated, and Title 24 Compliant

Catalog No.	Type:
Job Name:	

Specifications & Features:

Manufactured gasketed enclosures, which are totally dust and moisture resistant. The enclosure is constructed of a fiberglass upper body and an acrylic diffuser, crepe pattern diffuser securely positioned in a permanent poured in place sealing gasket. The diffuser and upper components are locked into place by retaining latches, assuring a secure, tight seal. Ideal for Food Processing, Kitchens, Parking Garages, Car Washes Schools, Government Facilities, Industrial Facilities, and Public Areas.

- Structurally rigid fiberglass body– fiberglass is reinforced polyester and self-extinguishing
- The gasketed inverted U-slot provides a positive continuous seal between body and diffuser
- Brass fixture Mounting stud– The fixture studs are integrally molded into the body to facilitate lighting and installation
- High Impact Acrylic Diffuser– Internal crepe pattern allows a smooth exterior surface for ease of cleaning
- Diffuser– The diffuser flange fits snugly into the gasketed retention slot forming a continuous seal
- Standard with mounting brackets

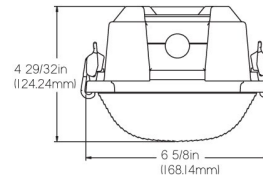

Radial Lens

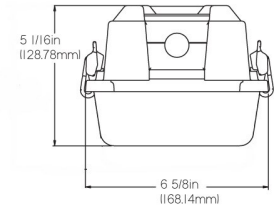

Standard

Catalog Ordering: Example: 7548-232-DIM

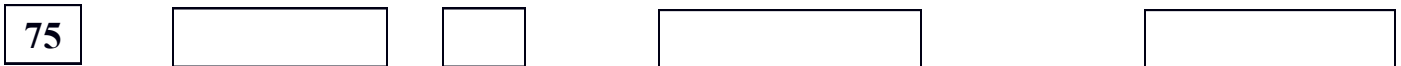

FAMILY TYPE	LENGTH IN INCHES/ LAMPING	# OF BALLAST	BALLAST/ VOLTAGE	OPTIONS
75	24-117 (1- F17T8)	/1	UNV (120-277 Volt)	EMR (450 Lumen Emergency Ballast)
	24-217 (2- F17T8)	/2	MVL (Instant Start Multi-Volt Low)	EMR 1400 (1400 Lumen Emergency Ballast)
	48-132 (1- F32T8)		MVN (Instant Start Multi-Volt Normal)	EX (Sensor Extension Bracket)
	48-232 (2- F32T8)		MVH (Instant Start Multi-Volt High)	OS (Occupancy Sensor)
	48-332 (3- F32T8)		MVPSL (Multi-Volt Program Start- Low)	OSD (Daylight/ Occupancy Sensor)
	96-T8-EL (2- F96T8)		MVPSN (Multi-Volt Program Start-Normal)	OSW (Occupancy Sensor– Wet)
	96-132T (2- F32T8)		MVPSH (Multi-Volt Program Start- High)	PC (Polycarbonate Diffuser)
	96-232T (4- F32T8)		IS/PS (1- Instant Start/ 1- Program Start)*	RL (Radial Lens)
	96-T8-EL-HO (2- F96T8HO)		DIM (Dimming Ballast)	WL (With Lamps)
	96-T12-EL-HO (2- F96T12-HO)		SDIM-73233 (GE 60% Step Dimming for Two T8)	TPL (Tamper Proof Latches)
	24-214 (2- F14T5)		SDIM-51496 (Osram 50% Step Dimming for 2 T5 Lamps)	
	24-224 (2- F24T5HO)		480 (480 Volt)	
	48-228 (2- F28T5)		480SD (480 Volt Step Down)	
	48-254 (2- F54T5HO)			
	96-228T (4- F28T5)			
	96-254T (4- F54T5HO)			

* Available with one Instant Start Ballast operating one lamp and one Program Start Ballast operating the other (Meant for a sensed fixture)

Specifications and Dimensions Subject to change without notice

FSC 9120 Center Avenue, Rancho Cucamonga, CA 91730 Ph 909-948-8878 Fax 909-948-8510

Revised 1/17/14

